

Non-Pressure DR18 Gasketed PVC C900 Fittings

DESIGN DATA

BELL SPECIFICATIONS

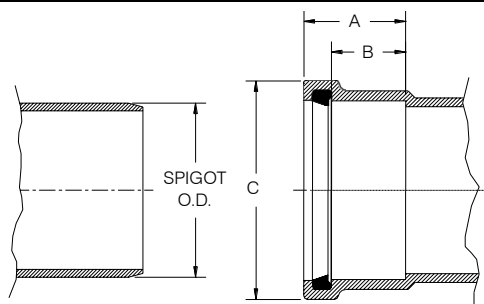

SIZE	STYLE	A	B	C	Spigot O.D.
4	M	4.3	3.1	6.3	4.80
6	M	4.8	3.5	8.6	6.90
8	M	5.4	4.0	11.0	9.05
10	F	9.0	5.0	13.0	11.10
12	F	9.5	5.5	15.5	13.20

COUPLING

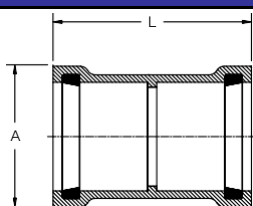

SIZE	PART #	STYLE	A	L	WT (approx.)
4	18NP-0804	M	6.3	8.9	2.9
6	18NP-0806	M	8.3	10.0	6.0
8	18NP-0808	M	11.0	11.0	11.5
10	18NP-0810	W	13.0	19.7	27
12	18NP-0812	W	15.5	22.3	40

Notes:

- All lay lengths & weights are approximate and are subject to change without notice
- Fabricated fitting configurations may vary

Style Legend:

- M - Molded
- W - Machined from extruded stock as manufactured by Westlake Pipe & Fittings
- F - Fabricated fittings are made from sections of PVC pipe

REPAIR COUPLING

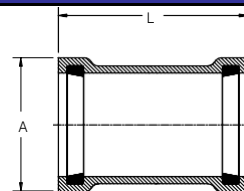

SIZE	PART #	STYLE	A	L	WT (approx.)
4	18NP-0904	M	6.3	8.9	3.4
6	18NP-0906	M	8.6	10.0	6.7
8	18NP-0908	M	11.0	11.3	12.5
10	18NP-0910	W	13.0	11.3	22
12	18NP-0912	W	15.5	12.1	36

TAPPED TEE (FNPT Thread)

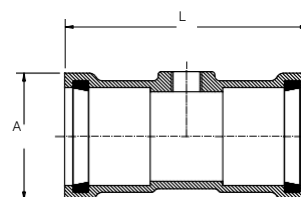

SIZE	PART #	STYLE	A	L	WT (approx.)
4 x 3/4	18NP-510403	M	6.9	12.0	5.0
4 x 1	18NP-510404	M	6.9	12.0	5.0
4 x 1 1/2	18NP-510406	M	6.9	12.0	5.0
4 x 2	18NP-510408	M	6.9	12.0	5.0
6 x 3/4	18NP-510603	M	8.5	13.0	9.2
6 x 1	18NP-510604	M	8.5	13.0	9.2
6 x 1 1/2	18NP-510606	M	8.5	13.0	9.2
6 x 2	18NP-510608	M	8.5	13.0	9.2
8 x 3/4	18NP-510803	M	11.0	14.9	16.0
8 x 1	18NP-510804	M	11.0	14.9	16.0
8 x 1 1/2	18NP-510806	M	11.0	14.9	16.0
8 x 2	18NP-510808	M	11.0	14.9	16.0

TAPPED TEE (AWWA Thread)

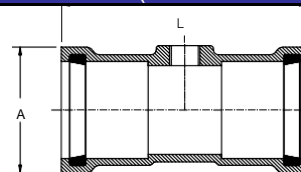

SIZE	PART #	STYLE	A	L	WT (approx.)
4 x 3/4	18NP-520403	M	6.9	12.0	4.3
4 x 1	18NP-520404	M	6.9	12.0	4.3
4 x 2	18NP-520408	M	6.9	12.0	4.3
6 x 3/4	18NP-520603	M	8.5	13.3	8.5
6 x 1	18NP-520604	M	8.5	13.3	8.5
6 x 2	18NP-520608	M	8.5	13.3	8.5
8 x 3/4	18NP-520803	M	11.0	14.9	15.0
8 x 1	18NP-520804	M	11.0	14.9	15.0
8 x 2	18NP-520808	M	11.0	14.9	15.0

Call For Other Sizes, Configurations & Gasket Materials



Harco Fittings LLC

P.O. BOX 10335 • LYNCHBURG, VIRGINIA 24506 • 3721 COHEN PLACE • LYNCHBURG, VIRGINIA 24501

PHONE: (434) 845-7094 • FAX: (434) 845-8562 • E-MAIL: sales@harcofittings.com • WEB: www.harcofittings.com

Non-Pressure DR18 Gasketed PVC C900 Fittings

DESIGN DATA

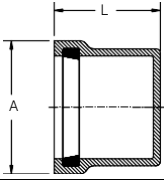
CAP					
					
(M fitting shown)					
SIZE	PART #	STYLE	A	L	WT (approx.)
4	18NP-4904	M	6.3	4.5	2.1
6	18NP-4906	M	8.6	5.2	4.5
8	18NP-4908	M	11.0	6.0	8.5
6	18NP-5006	M	8.0	5.0	4.5
10	18NP-4910	F	13.0	13.7	7.0
12	18NP-4912	F	15.5	17.8	10.0

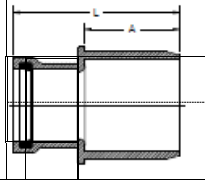
REDUCER (S x G)					
					
(M fitting shown)					
SIZE	PART #	STYLE	A	L	WT (approx.)
6 x 4	18NP-160604	M	4.7	9.4	4.0
8 x 6	18NP-160806	M	5.3	10.5	7.7
8 x 4	18NP-160804	F	8.0	16.2	14.0
10 x 4	18NP-161004	F	9.6	18.3	22.0
10 x 6	18NP-161006	F	11.0	20.5	28.0
10 x 8	18NP-161008	F	10.5	20.7	27.0
12 x 4	18NP-161204	F	9.6	20.3	35.0
12 x 6	18NP-161206	F	11.4	21.9	38.0
12 x 8	18NP-161208	F	10.5	23.7	45.0
12 x 10	18NP-161210	F	10.5	24.0	43.0

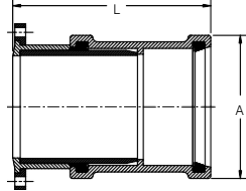
FLANGE ADAPTER (G x F)					
					
SIZE	PART #	STYLE	A	L	WT (approx.)
4	18NP-5404	MA	6.3	11.5	7.3
6	18NP-5406	MA	8.6	13.3	14.2
8	18NP-5408	MA	11.0	15.8	25.7

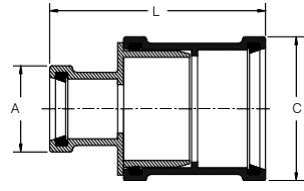
REDUCER (G x G)						
						
(MA fitting shown)						
SIZE	PART #	STYLE	A	C	L	WT (approx.)
6 x 4	18NP-170604	MA	6.3	8.6	13.6	10.4
8 x 6	18NP-170806	MA	8.6	11.0	15.3	19.6
8 x 4	18NP-170804	F	6.3	11.0	18.5	14.0
10 x 4	18NP-171004	F	6.3	13.0	23.1	22.0
10 x 6	18NP-171006	F	8.6	13.0	25.4	28.0
10 x 8	18NP-171008	F	11.0	13.0	25.5	27.0
12 x 4	18NP-171204	F	6.3	15.5	25.5	35.0
12 x 6	18NP-171206	F	8.6	15.5	27.0	38.0
12 x 8	18NP-171208	F	11.0	15.5	28.9	45.0
12 x 10	18NP-171210	F	13.0	15.5	29.0	43.0

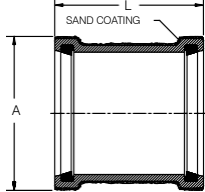
MALEHOLE ADAPTER (Double Bell – No Stop)					
					
(M fitting shown)					
SIZE	PART #	STYLE	A	L	WT (approx.)
4	18NP-5704	M	8.9	6.5	3.4
6	18NP-5706	M	10.0	8.8	8.0
8	18NP-5706	M	11.3	11.2	15.0
10	18NP-5710	F	13.3	18.0	24.0
12	18NP-5712	F	15.8	18.0	28.0

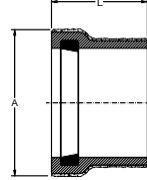
MALEHOLE ADAPTER (Single Bell – No Stop)					
					
SIZE	PART #	STYLE	A	L	WT (approx.)
8	18NP-5808	FTO	11.1	5.7	6.3
10	18NP-5810	FTO	13.1	9.0	11.0
12	18NP-5812	FTO	15.6	9.0	18.0

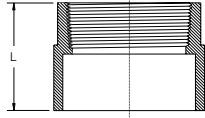
CLEAN-OUT ADAPTER (Hub)				
				
SIZE	PART #	STYLE	L	WT (approx.)
4	18NP-5904	M (Solvent Weld)	3.3	0.6
6	18NP-5906	M (Solvent Weld)	4.4	1.3

Notes:

- All lay lengths & weights are approximate and are subject to change without notice
- Fabricated fitting configurations may vary

Style Legend:

M - Molded
 F - Fabricated fittings are made from sections of PVC pipe
 FTO - Fabricated To Order

Call For Other Sizes, Configurations & Gasket Materials



Harco Fittings LLC

P.O. BOX 10335 • LYNCHBURG, VIRGINIA 24506 • 3721 COHEN PLACE • LYNCHBURG, VIRGINIA 24501
 PHONE: (434) 845-7094 • FAX: (434) 845-8562 • E-MAIL: sales@harcofittings.com • WEB: www.harcofittings.com

Non-Pressure DR18 Gasketed PVC C900 Fittings

DESIGN DATA

90° BEND (G x G)

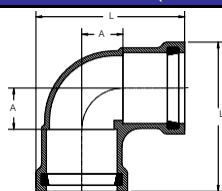

(M fitting shown)

SIZE	PART #	STYLE	A	L	WT (approx.)
4	18NP-1804	M	2.8	10.3	6.0
6	18NP-1806	M	3.9	13.1	12.0
8	18NP-1808	M	5.1	16.0	23.0
10	18NP-1810	F	12.0	28.5	52.0
12	18NP-1812	F	14.0	34.5	80.0

11¼° BEND (G x G)

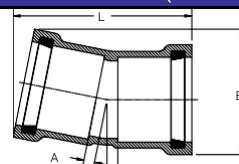

(M fitting shown)

SIZE	PART #	STYLE	A	B	L	WT (approx.)
4	18NP-2804	M	0.6	7.3	10.5	3.8
6	18NP-2806	M	0.8	9.3	12.0	7.5
8	18NP-2808	M	0.9	11.8	13.5	13.1
10	18NP-2810	F	1.0	14.0	26.0	34.0
12	18NP-2812	F	1.0	15.5	28.5	55.0

45° BEND (G x G)

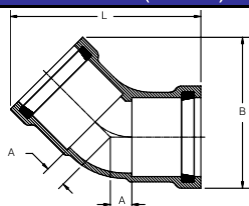

(M fitting shown)

SIZE	PART #	STYLE	A	B	L	WT (approx.)
4	18NP-2204	M	1.3	9.9	11.5	4.1
6	18NP-2206	M	1.8	12.6	14.0	8.2
8	18NP-2208	M	2.2	14.8	16.8	16.1
10	18NP-2210	F	8.8	22.5	26.0	42.0
12	18NP-2212	F	8.9	23.0	29.0	68.0

90° BEND (G x S)

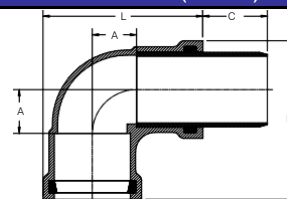

(MA fitting shown)

SIZE	PART #	STYLE	A	B	C	L	WT (approx.)
4	18NP-1904	MA	2.8	10.3	4.3	10.3	6.0
6	18NP-1906	MA	3.9	13.1	4.5	13.1	12.0
8	18NP-1908	MA	5.1	16.0	4.8	16.0	23.0
10	18NP-1910	F	12.0	28.5	10.5	28.5	45.0
12	18NP-1912	F	14.0	34.5	10.5	34.5	70.0

22½° BEND (G x G)

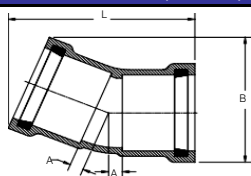

(M fitting shown)

SIZE	PART #	STYLE	A	B	L	WT (approx.)
4	18NP-2404	M	0.8	8.0	11.0	4.0
6	18NP-2406	M	1.1	10.3	13.0	8.0
8	18NP-2408	M	1.3	13.3	15.0	15.0
10	18NP-2410	F	6.6	16.0	26.8	36.0
12	18NP-2412	F	7.8	19.3	28.5	60.0

45° BEND (G x S)

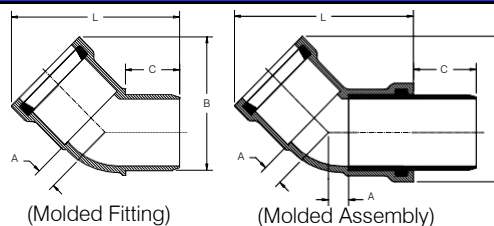

(Molded Fitting)

(Molded Assembly)

SIZE	PART #	STYLE	A	B	C	L	WT (approx.)
4	18NP-2304	M	1.3	9.9	3.6	11.5	3.5
6	18NP-2306	M	1.8	12.6	3.8	14.0	7.7
8	18NP-2308	MA	2.2	14.8	4.8	16.8	16.1
10	18NP-2310	F	8.8	22.5	10.5	26.0	35.0
12	18NP-2312	F	8.9	23.0	10.5	29.0	58.0

Call For Other Sizes, Configurations & Gasket Materials

Notes:

- All lay lengths & weights are approximate and are subject to change without notice
- Fabricated fitting configurations may vary

Style Legend:

- M - Molded
- F - Fabricated fittings are made from sections of PVC pipe
- MA - Assembled from molded or extruded components

22½° BEND (G x S)

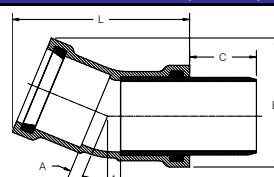

(MA fitting shown)

SIZE	PART #	STYLE	A	B	C	L	WT (approx.)
4	18NP-2504	MA	0.8	8.0	4.3	11.0	4.0
6	18NP-2506	MA	1.1	10.3	4.5	13.0	8.0
8	18NP-2508	MA	1.3	13.3	4.8	15.0	15.0
10	18NP-2510	F	6.6	15.5	10.5	26.8	35.0
12	18NP-2512	F	7.8	19.5	10.5	28.5	58.0



Harco Fittings LLC

P.O. BOX 10335 • LYNCHBURG, VIRGINIA 24506 • 3721 COHEN PLACE • LYNCHBURG, VIRGINIA 24501

PHONE: (434) 845-7094 • FAX: (434) 845-8562 • E-MAIL: sales@harcofittings.com • WEB: www.harcofittings.com

DD_PC9_20230203

Non-Pressure DR18 Gasketed PVC C900 Fittings

DESIGN DATA

11¼° BEND (G x S)

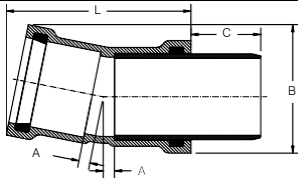

(MA fitting shown)

SIZE	PART #	STYLE	A	B	C	L	WT (approx.)
4	18NP-2904	MA	0.6	7.3	4.3	10.5	3.8
6	18NP-2906	MA	0.8	9.3	4.5	12.0	7.5
8	18NP-2908	MA	0.9	11.8	4.75	13.5	13.1
10	18NP-2910	F	1.0	14.0	10.5	14.5	33.0
12	18NP-2912	F	1.0	15.5	10.5	16.3	53.0

45° WYE – C900 x Sewer (G x G x G)

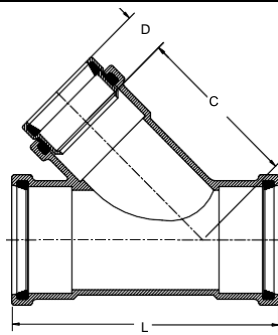

(MA fitting shown)

SIZE	PART #	STYLE	C	D	L	WT (approx.)
4 x 4	18NP-6650404	MA	6.8	2.7	16.8	9.0
6 x 4	18NP-6650604	MA	9.6	2.7	21.3	16.0
6 x 6	18NP-6650606	MA	9.6	3.5	21.3	21.0
8 x 4	18NP-6650804	M	9.8	2.7	18.7	29.1
8 x 6	18NP-6650806	MA	10.2	3.5	21.8	29.0
8 x 8	18NP-6650808	FTO	14.0	4.0	34.4	60.0

ADAPTER – C900 x SEWER (GxG)

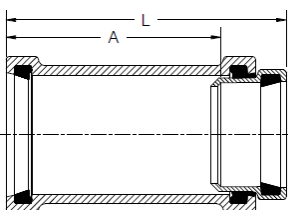

(Molded Assembly)

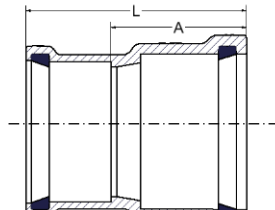

(Molded Fitting)

SIZE	PART #	STYLE	A	L	WT (approx.)
4	18NP-39004	MA	7.7	10.4	2.0
6	18NP-39006	M	6.1	9.9	2.0
8	18NP-39008	M	6.7	10.7	7.5
10	18NP-39010	F	12.0	19.5	12.0
12	18NP-39012	F	13.5	21.0	18.0

45° WYE (G x G x G) (continued)

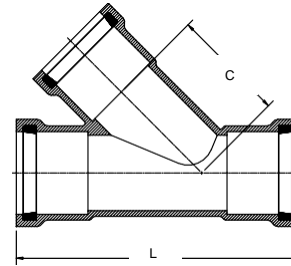

SIZE	PART #	STYLE	C	L	WT (approx.)
4 x 4	18NP-010404	M	6.8	16.8	8.2
6 x 4	18NP-010604	MA	9.6	21.3	15.0
6 x 6	18NP-010606	M	9.6	21.3	19.1
8 x 4	18NP-010804	M	9.7	19.0	23.5
8 x 6	18NP-010806	M	10.2	21.8	27.0
8 x 8	18NP-010808	F	10.0	34.4	39.0
10 x 4	18NP-011004	F	9.8	31.0	40.0
10 x 6	18NP-011006	F	9.7	33.5	48.0
10 x 8	18NP-011008	F	10.2	36.5	53.0
10 x 10	18NP-011010	F	11.4	39.5	53.0
12 x 4	18NP-011204	F	10.7	34.0	61.0
12 x 6	18NP-011206	F	11.2	36.8	70.0
12 x 8	18NP-011208	F	11.7	39.8	81.0
12 x 10	18NP-011210	F	12.9	42.5	97.0
12 x 12	18NP-011212	F	15.4	46.5	114.0

ADAPTER – C900 x Sewer (S x G)

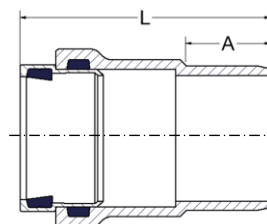

(Molded Assembly)

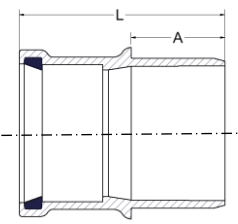

(Molded Fitting)

SIZE	PART #	STYLE	A	L	WT (approx.)
4	18NP-39204	MA	2.7	8.2	4.0
6	18NP-39206	M	3.7	10.0	6.0
8	18NP-39208	M	5.4	10.7	12.0
10	18NP-39210	F	9.25	17.8	21.0
12	18NP-39212	F	10.0	18.8	31.0

Notes:

- All lay lengths & weights are approximate and are subject to change without notice
- Fabricated fitting configurations may vary

Style Legend:

- M - Molded
- F - Fabricated fittings are made from sections of PVC pipe
- FTO - Fabricated To Order
- MA - Assembled from molded or extruded components

Call For Other Sizes, Configurations & Gasket Materials



Harco Fittings LLC

P.O. BOX 10335 • LYNCHBURG, VIRGINIA 24506 • 3721 COHEN PLACE • LYNCHBURG, VIRGINIA 24501

PHONE: (434) 845-7094 • FAX: (434) 845-8562 • E-MAIL: sales@harcofittings.com • WEB: www.harcofittings.com

Non-Pressure DR18 Gasketed PVC C900 Fittings

DESIGN DATA

ADAPTER – C900 x Sewer (G x S)

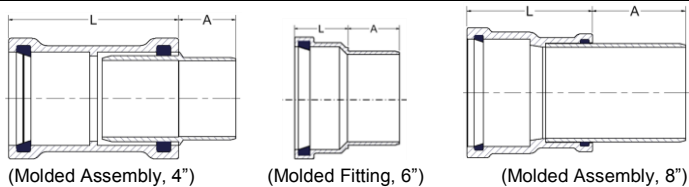

SIZE	PART #	STYLE	A	L	WT (approx.)
4	18NP-39104	MA	3.0	8.9	4.0
6	18NP-39106	M	3.4	3.6	2.0
8	18NP-39108	MA	8.6	10.7	15.0

ADAPTER – C900 x IPS (S x G)

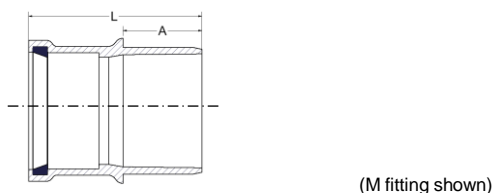

SIZE	PART #	STYLE	A	L	WT (approx.)
4	18NP-37204	M	2.7	7.1	2.4
6	18NP-37206	M	4.3	9.5	5.0
8	18NP-37208	F			28.0

TEE (G x G x G)

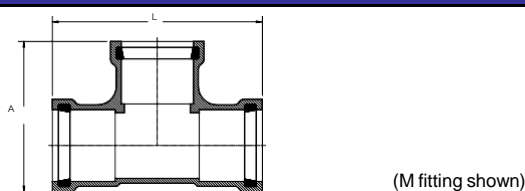

SIZE	PART #	STYLE	A	L	WT (approx.)
4 x 4	18NP-120404	M	10.1	14.2	6.7
6 x 4	18NP-120604	M	12.3	15.4	11.5
6 x 6	18NP-120606	M	13.0	17.4	14.5
8 x 4	18NP-120804	M	14.9	16.3	19.0
8 x 6	18NP-120806	M	15.4	18.5	23.0
8 x 8	18NP-120808	M	16.0	20.9	26.0
10 x 4	18NP-121004	F	22.0	29.3	37
10 x 6	18NP-121006	F	23.0	30.3	40
10 x 8	18NP-121008	F	22.5	33.0	43
10 x 10	18NP-121010	F	22.5	35.5	68
12 x 4	18NP-121204	F	24.0	32.5	56
12 x 6	18NP-121206	F	25.0	33.5	60
12 x 8	18NP-121208	F	26.5	36.5	65
12 x 10	18NP-121210	F	26.0	38.5	72
12 x 12	18NP-121212	F	26.0	40.5	99

ADAPTER – C900 x IPS (G x G)

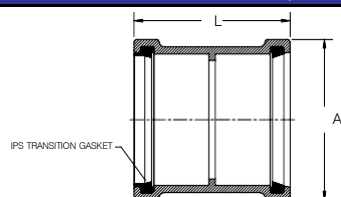

SIZE	PART #	STYLE	A	L	WT (approx.)
4	18NP-37004	M	6.3	8.9	2.9
6	18NP-37006	M	8.3	10.0	6.0
8	18NP-37008	M	11.1	11.3	12.5

TAPPED PLUG (FNPT Thread)

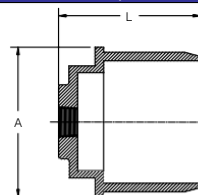

SIZE	PART #	STYLE	A	L	WT (approx.)
4 x 3/4	18NP-450403	M	5.3	4.5	1.2
4 x 1	18NP-450404	M	5.3	4.5	1.2
4 x 1 1/2	18NP-450406	M	5.3	4.5	1.2
4 x 2	18NP-450408	M	5.3	4.5	1.2
6 x 3/4	18NP-450603	M	7.4	6.4	3.1
6 x 1	18NP-450604	M	7.4	6.4	3.1
6 x 1 1/2	18NP-450606	M	7.4	6.4	3.1
6 x 2	18NP-450608	M	7.4	6.4	3.1
8 x 3/4	18NP-450803	M	9.5	7.3	6.2
8 x 1	18NP-450804	M	9.5	7.3	6.2
8 x 1 1/2	18NP-450806	M	9.5	7.3	6.2
8 x 2	18NP-450808	M	9.5	7.3	6.2

PLUG

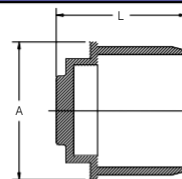

SIZE	PART #	STYLE	A	L	WT (approx.)
4	18NP-4404	M	5.3	4.5	1.2
6	18NP-4406	M	7.4	6.4	3.1
8	18NP-4408	M	9.5	7.3	6.2
10	18NP-4410	F	12.3	14.0	21.0
12	18NP-4412	F	14.5	14.0	32.0

Style Legend:

- F - Fabricated fittings are made from sections of PVC pipe
- M - Molded
- MA - Assembled from molded or extruded components

Call For Other Sizes, Configurations & Gasket Materials

Notes:

- All lay lengths & weights are approximate and are subject to change without notice
- Fabricated fitting configurations may vary



Harco Fittings LLC

P.O. BOX 10335 • LYNCHBURG, VIRGINIA 24506 • 3721 COHEN PLACE • LYNCHBURG, VIRGINIA 24501

PHONE: (434) 845-7094 • FAX: (434) 845-8562 • E-MAIL: sales@harcofittings.com • WEB: www.harcofittings.com

Non-Pressure DR18 Gasketed PVC C900 Fittings

DESIGN DATA

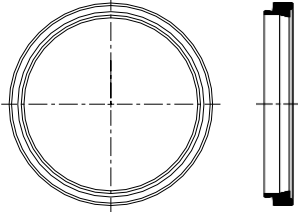
TRANSITION GASKET - C900 x IPS			
			
SIZE	PART #	STYLE	WT (approx.)
4	18NP-G9604	M	0.3
6	18NP-G9606	M	0.5
8	18NP-G9608	M	0.7

Call For Other Sizes, Configurations & Gasket Materials

Style Legend:

M - Molded



Harco Fittings LLC

P.O. BOX 10335 • LYNCHBURG, VIRGINIA 24506 • 3721 COHEN PLACE • LYNCHBURG, VIRGINIA 24501
PHONE: (434) 845-7094 • FAX: (434) 845-8562 • E-MAIL: sales@harcofittings.com • WEB: www.harcofittings.com
DD_PC9_20230203