



**Material Specifications:**

**Fitting:**

Ductile iron conforming to ASTM A-536, grade 65-45-12.

**Fitting Coating:**

Orange enamel

Red enamel in Europe, Middle East, Africa, and India

Optional: Hot dipped galvanized

**Approvals/Listings:**



**Product Description:**

FireLock® products comprise a unique system specifically designed for fire protection services. FireLock full-flow elbows and tees feature CAD-developed, hydrodynamic design, affording a shorter center-to-end dimension than standard fittings. A noticeable bulge allows the water to make a smoother turn to maintain similar flow characteristics as standard full flow fittings.

FireLock fittings are designed for use exclusively with Victaulic couplings that have been Listed or Approved for Fire Protection Services. Use of other couplings or flange adapters may result in bolt pad interference.

Refer to the appropriate listing agency or approval body for pressure ratings. Pressure ratings vary by agency.

**Job/Owner**

System No.	
Location	

**Contractor**

Submitted By	
Date	

**Engineer**

Spec Section	
Paragraph	
Approved	
Date	

**Dimensions:**

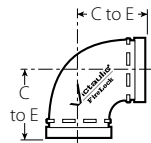

NO. 001

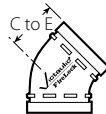

NO. 003

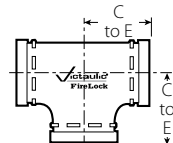

NO. 002



No. 006

Nominal Size inches mm	Actual Outside Diameter inches mm	No. 001 90° Elbow		No. 003 45° Elbow		No. 002 Straight Tee		No. 006 Cap	
		C to E inches mm	Approx. Weight Each Lbs. kg	C to E inches mm	Approx. Weight Each Lbs. kg	C to E inches mm	Approx. Weight Each Lbs. kg	C to E inches mm	Approx. Weight Each Lbs. kg
1 ¼ 32	1.660 42.4	—	—	—	—	—	—	0.82 21	0.3 0.1
1 ½ 40	1.900 48.3	—	—	—	—	—	—	0.82 21	0.4 0.2
2 50	2.375 60.3	2.75 70	1.7 0.8	2.00 51	1.8 0.8	2.75 70	2.4 1.1	0.88 22	0.6 0.3
2 ½ 65	2.875 73.0	3.00 76	3.1 1.4	2.25 57	2.2 1.0	3.00 76	3.6 1.6	0.88 22	1.0 0.5
76.1 mm	3.000 76.1	3.00 76	3.30 1.5	2.25 57	2.4 1.1	3.00 76.2	3.8 1.7	—	—
3 80	3.500 88.9	3.38 86	4.0 1.8	2.50 64	3.1 1.4	3.38 86	5.3 2.4	0.88 22	1.2 0.5
108 mm	4.250 108.0	4.00 102	5.7 2.6	3.00 76	5.1 2.3	4.00 102	7.5 3.4	—	—
4 100	4.500 114.3	4.00 102	6.7 3.0	3.00 76	5.6 2.5	4.00 102	8.7 3.9	1.00 25	2.4 1.1
5 125	5.563 141.3	4.88 124	12.6 5.7	3.25 83	8.3 3.8	4.88 124	15.7 7.1	1.00 25	4.1 1.9
139.7 mm	5.500 139.7	4.88 124.0	12.4 5.6	3.25 82.6	8.2 3.7	4.88 124.0	15.4 6.9	—	—
159 mm	6.250 158.8	5.50 140	12.6 5.7	3.50 89	9.2 4.2	5.50 140	17.9 8.0	—	—
6 150	6.625 168.3	5.50 140	18.3 8.3	3.50 89	11.7 5.3	5.50 140	22.7 10.3	1.00 25	5.9 2.7
165.1 mm	6.500 165.1	5.43 139.7	17.6 7.9	3.50 88.9	11.4 5.2	5.50 139.7	22.0 9.9	—	—
8 200	8.625 219.1	6.81 173	25.5 11.6	4.25 108	20.4 9.3	6.94 176	38.7 17.6	1.13 29	12.7 5.8

**Flow Data:**

Nominal Size	Actual Outside Diameter	Frictional Resistance Equivalent Feet/meters of Straight Pipe <sup>1</sup>			
		Elbows		No. 002 Straight Tee	
		No. 001 90° Elbow	No. 003 45° Elbow	Branch	Run
1 ¼ 32	1.660 42.4	—	—	—	—
1 ½ 40	1.900 48.3	—	—	—	—
2 50	2.375 60.3	3.5 1.1	1.8 0.5	8.5 2.6	3.5 1.1
2 ½ 65	2.875 73.0	4.3 1.3	2.2 0.7	10.8 3.3	4.3 1.3
76.1 mm	3.000 76.1	4.5 1.4	2.3 0.7	11.0 3.4	4.5 1.4
3 80	3.500 88.9	5.0 1.5	2.6 0.8	13.0 4.0	5.0 1.5
108 mm	4.250 108.0	6.4 2.0	3.2 0.9	15.3 4.7	6.4 2.0
4 100	4.500 114.3	6.8 2.1	3.4 1.0	16.0 4.9	6.8 2.1
5 125	5.563 141.3	8.5 2.6	4.2 1.3	21.0 6.4	8.5 2.6
139.7 mm	5.500 139.7	8.3 2.5	4.1 1.3	20.6 6.3	8.3 2.5
159 mm	6.250 158.8	9.4 2.9	4.9 1.5	25.0 7.6	9.6 2.9
6 150	6.625 168.3	10.0 3.0	5.0 1.5	25.0 7.6	10.0 3.0
165.1 mm	6.500 165.1	9.8 3.0	4.9 1.5	24.5 7.5	9.8 3.0
8 200	8.625 219.1	13.0 4.0	5.0 1.5	33.0 10.1	13.0 4.0

<sup>1</sup> The flow data listed is based upon the pressure drop of Schedule 40 pipe.

**General Notes:**

NOTE: When assembling FireLock EZ couplings onto end caps, take additional care to make certain the end cap is fully seated against the gasket end stop. For FireLock EZ Style 009N/009H couplings, use FireLock No. 006 end caps containing the “EZ” marking on the inside face or No. 60 end caps containing the “QV EZ” marking on the inside face. Non-Victaulic end cap products shall not be used with Style 009/009V/009H couplings.

**Installation**

Reference should always be made to the [I-100 Victaulic Field Installation Handbook](#) for the product you are installing. Handbooks are included with each shipment of Victaulic products for complete installation and assembly data, and are available in PDF format on our website at [www.victaulic.com](http://www.victaulic.com).

**Warranty**

Refer to the Warranty section of the current Price List or contact Victaulic for details.

**Note**

This product shall be manufactured by Victaulic or to Victaulic specifications. All products to be installed in accordance with current Victaulic installation/assembly instructions. Victaulic reserves the right to change product specifications, designs and standard equipment without notice and without incurring obligations.

**Trademarks**

Victaulic® is a registered trademark of Victaulic Company.